

## » Thread inserts - DIN 8140

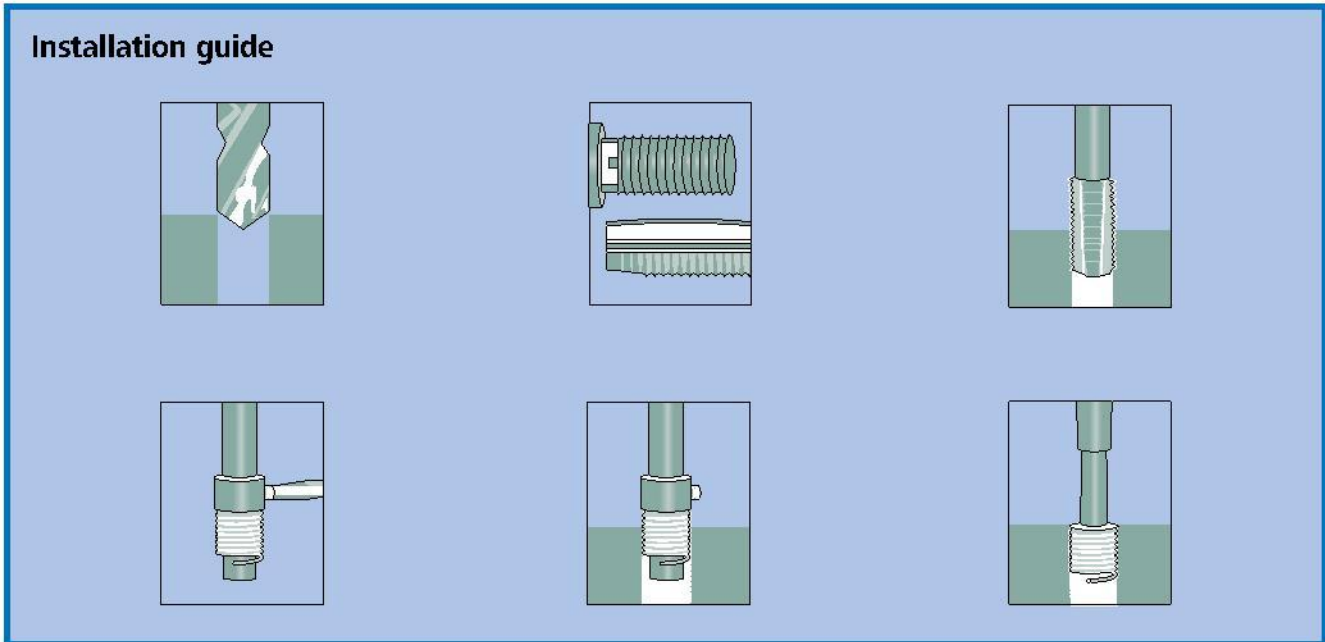

### Continuous, rust-free steel, type standard

V - COIL Thread inserts consist of high-quality chromium-nickel steel and provide for fixed internal threads which are temperature- and corrosion-resistant. To fit as repairing damaged and worn-out threads. Tolerance ISO 2 (6H)



### Metric thread

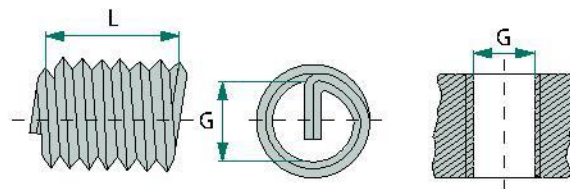

PIECE

Part no.	Thread	Length (mm)	Drill Ø (mm)	Hand fitting tool no.	PP
48507308	M5	7	5,2	8	1
48507309	M6	9	6,3	9	1
48507311	M8	12	8,3	11	1
48507312	M8x1	12	8,3	11	1
48507315	M10	15	10,4	13	1
48507317	M10x1	15	10,3	13	1
48507321	M12	18	12,4	15	1
48507322	M12x1,5	18	12,4	15	1
48507325	M14	21	14,5	16	1
48507327	M14x1,25	21	14,4	17	1
48507326	M14x1,5	21	14,4	16	1
48507334	M16	24	16,5	18	1
48507335	M16x1,5	24	16,4	18	1
48507336	M18	27	18,6	20	1
48507338	M18x1,5	27	18,5	20	1
48507339	M20	30	20,6	21	1
48507341	M20x1,5	30	20,5	21	1
48507342	M22	33	22,6	22	1
48507344	M22x1,5	33	22,5	22	1
48507345	M24	36	24,75	23	1
48507347	M24x1,5	36	24,5	23	1

NEW



## » Thread inserts - DIN 8140

Continuous, rust-free steel, type standard

V - COIL Thread inserts consist of high-quality chromium-nickel steel and provide for fixed internal threads which are temperature- and corrosion-resistant. To fit as repairing damaged and worn-out threads. Tolerance ISO 2 (6H)

Imperial tube - thread (BSP)

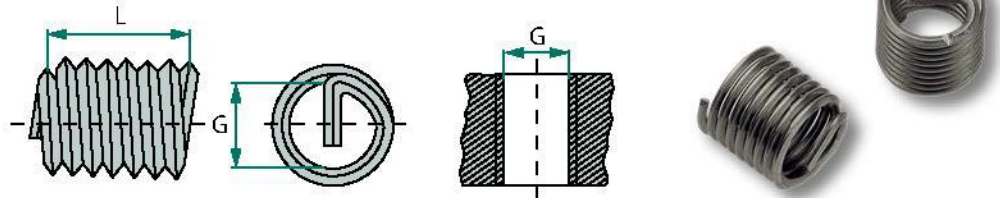

PIECE

Part no.	Thread	Length (mm)	Drill Ø (mm)	PP
48508381	G 1/4"	20	13,6	1
48508382	G 3/8"	25	17,1	1

Part no.	Thread	Length (mm)	Drill Ø (mm)	PP
48508383	G 1/2"	31	21,5	1

Continuous, rust-free steel, type standard

V - COIL Thread inserts consist of high-quality chromium-nickel steel and provide for fixed internal threads which are temperature- and corrosion-resistant. To fit as repairing damaged and worn-out threads. Tolerance ISO 2 (6H)



Imperial tube - thread (UNC)

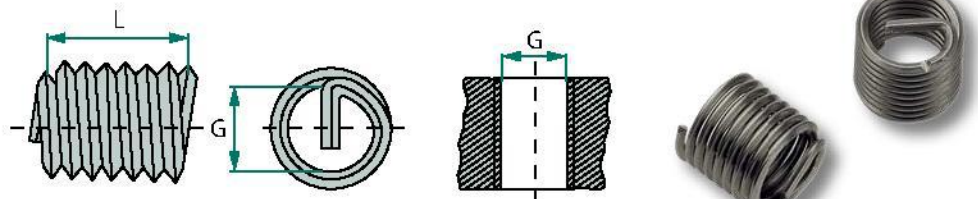

PIECE

Part no.	Thread	Length (mm)	Drill Ø (mm)	Hand fitting tool no.	PP
48508307	1/4"	9,5	6,7	9	1
48508308	5/16"	12	8,3	10	1
48508309	3/8"	14,0	9,9	12	1
48508310	7/16"	16,5	11,6	14	1
48508311	1/2"	19,0	13,0	15	1

### MY TIP:



#### Original V-COIL Thread-repair assortment

- for thread sizes M5 up to M12
- includes the relevant drills, screwing-in device and thread breaker
- in robust plastic case

Part no.: 48504081

Further details of this product can be found on page 576.



Stephan Stengel  
 Customer Advisor  
 GRANIT Customer Centre



## » Short machine taps

For thread inserts  
 Metric

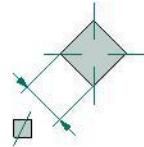
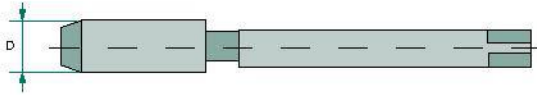

Part no.	For thread	Ø D (mm)	Square (mm)	Drill Ø (mm)	PP
48503008	M5	6	5,0	5,20	1
48503009	M6	7,3	6,3	6,3	1
48503011	M8	9,6	8	8,3	1
48503012	M8x1	9,3	8	8,3	1
48503015	M10	11,9	7,1	10,4	1
48503017	M10x1	11,3	6,3	10,3	1
48503020	M12	14,3	9	12,4	1
48503021	M12x1,5	14	9	12,4	1
48503027	M14	16,6	10	14,5	1
48503029	M14x1,25	15,6	10	14,4	1
48503033	M16	18,6	12,2	16,5	1
48503034	M16x1,5	18	11,2	16,4	1
48503035	M18	21,3	12,5	18,6	1
48503037	M18x1,5	20	11,2	18,5	1
48503038	M20	23,3	12,5	20,6	1
48503040	M20x1,5	22	12,5	20,5	1
48503041	M22	25,3	14	22,6	1
48503043	M22x1,5	24	14	22,5	1
48503044	M24	27,9	16	24,75	1
48503046	M24x1,5	26	18	24,5	1

For thread inserts  
 Imperial UNC

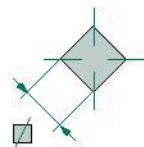
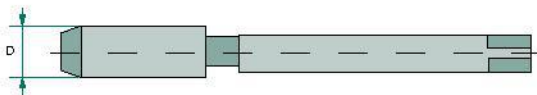

Part no.	For thread	Ø D (mm)	Square (mm)	Drill	PP
48503107	1/4"	8	6,3	6,7	1
48503108	5/16"	9,8	8	8,3	1
48503109	3/8"	11,8	6,3	9,9	1
48503110	7/16"	13,5	9	11,6	1
48503111	1/2"	15,2	10	13	1

### » STI Tap inserts



2 pieces for thread inserts  
 R-thread (BSP)



Part no.	For thread	Ø D (mm)	Square (mm)	Drill Ø (mm)	PP
48503312	G 1/4"	14,7	9	13,6	1
48503313	G 3/8"	18,3	11,2	17,1	1
48503314	G 1/2"	23,1	12,5	21,5	1

### » Hand fitting tools



With locking ring, for thread sockets



06

Part no.	Tool no.	Metric thread	Imperial thread	PP
48508008	8	M5	-	1
48508009	9	M6	1/4" UNC	1
48508010	10	-	5/16" UNC	1
48508011	11	M8, M8x1	-	1
48508012	12	-	3/8" UNC	1
48508013	13	M10, M10x1	-	1
48508014	14	-	7/16" UNC	1
48508015	15	M12, M12x1,5	1/2" UNC	1
48508016	16	M14	-	1
48508017	17	M14x1,25	-	1
48508018	18	M16, M16x1,5	-	1
48508020	20	M18, M18x1,25	-	1
48508021	21	M20, M20x1,5	-	1
48508022	22	M22, M22x1,5	-	1
48508023	23	M24, M24x1,5	-	1

### » Fitting tools



With hexagon interface 1/2"  
 For thread inserts

Part no.	Imperial R-thread (BSP)	PP
48508081	G 1/4"	1
48508082	G 3/8"	1
48508083	G 1/2"	1





## » Pin breakers

For thread inserts



Part no.	Metric thread	Imperial thread	Tool no.	PP
48507008	M5	-	8	1
48507009	M6	1/4" UNC	9	1
48507011	M8, M8x1	5/16" UNC	11	1
48507012	-	3/8" UNC	12	1
48507013	M10, M10x1	-	13	1
48507014	-	7/16" UNC	14	1
48507015	M12, M12x1,5	1/2" UNC	15	1

## » Extractor tools

For thread inserts

Part no.	Metric thread	Imperial thread	PP
48507052	M3 bis M10	3/16" bis 3/8"	1
48507053	M11 bis M24	3/8" bis 1"	1



## » Thread repair assortment

M5 up to M12 in metal box

Part no.	Contents	PP
48504081	Thread inserts: 25x M5, 25x M6, 25x M8, 25x M10 and 10x M12, each with 1 drill 5,2, 6,3, 8,3, 10,4 and 12,4 Additionally with screwing-in tool and pin breaker no. 8, 9, 11, 13 and 15	1

